

VITAL INJECTOR™ SYSTEM

Quick Guideline

Injector Structure

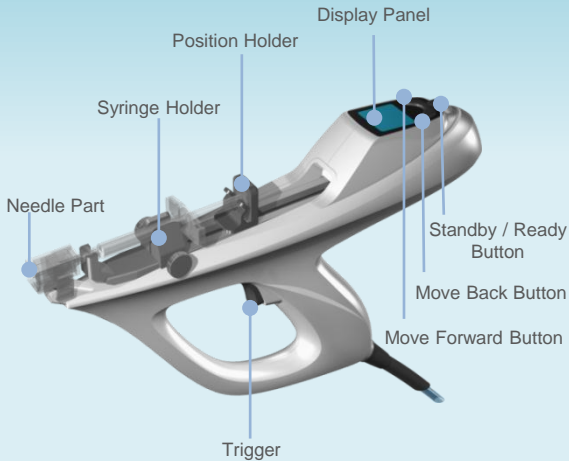

Body Control LCD

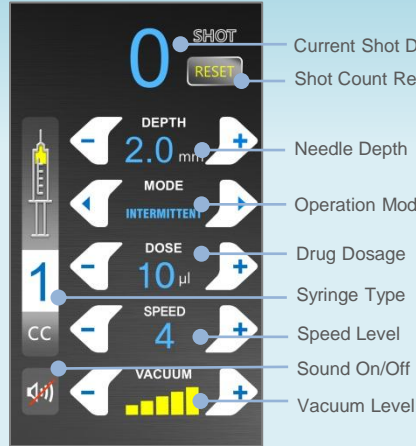

Injector LCD

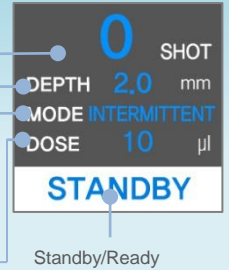

Installation

1. Turn on the power

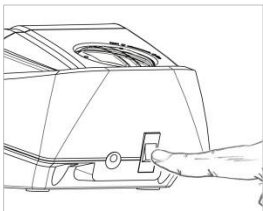

Turn on the power switch.

2. Connecting multi-needle

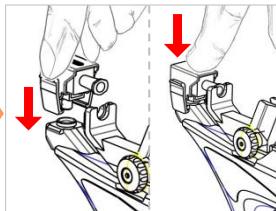

Match the multi-needle vacuum hall to the injector vacuum hall, and then press the upper part of the multi-needle until you hear a "click" sound.

3. Remove safe tape

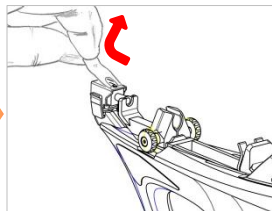

Remove the safe tape on the multi-needle.

6. Fasten the syringe holder

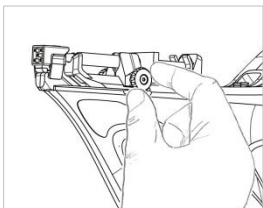

Fasten the syringe holder.

5. Connecting syringe and multi-needle

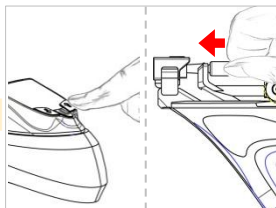

Connect the syringe to the multi-needle connect hall by pressing the forward button. After that push the syringe tightly by hand.

4. Syringe Installation

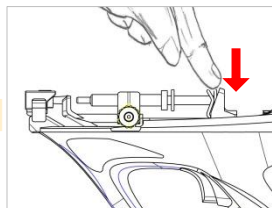

Put the syringe on the injector, then place the syringe piston correctly in the position holder.

Preparation

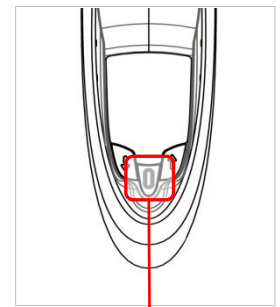

Standby/Ready Button

- Standby : Treatment standby mode
- Ready : Treatment ready mode



Move Back Button

- Move back the position holder.
- When pressed for more than two seconds, the position holder move back automatically, and press shortly once is to stop the motion.



Move Forward Button

- Move forward the position holder.

※ Press the injector trigger until removing the remaining air in the syringe before treatment.

VITAL INJECTOR™ SYSTEM

Quick Guideline

Operation

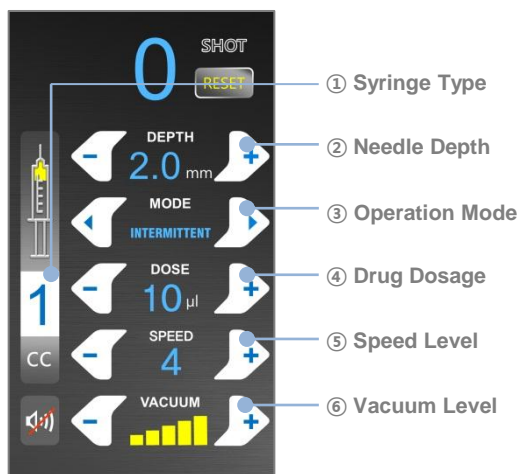

④ Drug Dosage

Set a target drug dosage of the treatment.

Intermittent Mode [Preset : 10 µl]

Type	Dose	Available Shot	Dose	Available Shot
1 cc Syringe	7 µl (1.4µl/psm)	143	13 µl (2.6µl/psm)	77
	8 µl (1.6µl/psm)	125	14 µl (2.8µl/psm)	72
	9 µl (1.8µl/psm)	111	15 µl (3.0µl/psm)	67
	10 µl (2.0µl/psm)	100	20 µl (4.0µl/psm)	50
	11 µl (2.2µl/psm)	90	25 µl (5.0µl/psm)	40
	12 µl (2.4µl/psm)	83	30 µl (6.0µl/psm)	33

Type	Dose
1 cc	1 cc/min, 2 cc/min, 3 cc/min
2 cc	1 cc/min, 3 cc/min, 5 cc/min
3 cc	
5 cc	

① Syringe Type [Preset : 1cc]

Select a correct syringe on the screen.

Syringe Type
1 cc, 2 cc, 3 cc, 5 cc

② Needle Depth [Preset : 2.0mm]

Set a target needle penetration depth.

Needle Depth Setting
Min. 0 mm ~ Max. 5.0 mm (Interval : 0.2mm)

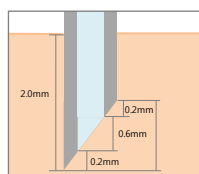

* Needle bevel

Refer to the left figure

e.g.) [Set depth: 2.0mm]

→ [Target area: about 1.2 ~ 1.8mm]

⑤ Speed Level [Preset : 4 Level]

Depending on the drug viscosity, set the staying time of needles in the skin.



Low Viscosity [Liquid type]		High Viscosity [Gel type : e.g. VITAL]	
Dose	Speed	Dose	Speed
7~8 µl	1	-	1
9~10 µl	2	-	2
11~12 µl	3	7~8 µl	3
13~14 µl	4	9~10 µl	4
15 ~ µl	5	11~12 µl	5
15 ~ µl	6	13~14 µl	6

③ Operation Mode [Preset : Intermittent]

Select operation mode.

Operation Mode
Intermittent: When you pull the trigger once injected drugs.
Continuous: When you continue pulling the trigger, the drug is injected continuously.

⑥ Vacuum Level [Preset : 5 Level]

Set a target vacuum level.

