

# VITAL INJECTOR™ SYSTEM

## Quick Guideline

### Injector Structure

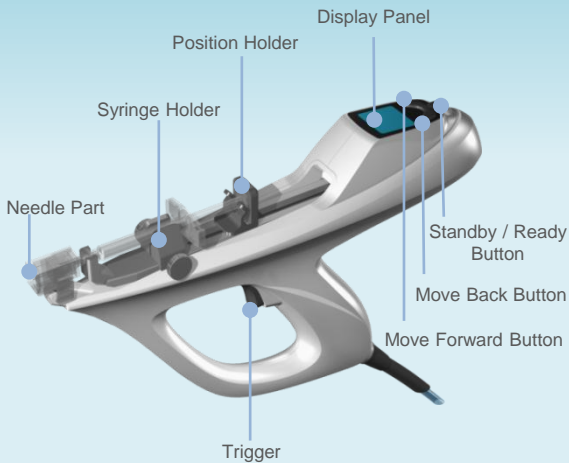

### Body Control LCD

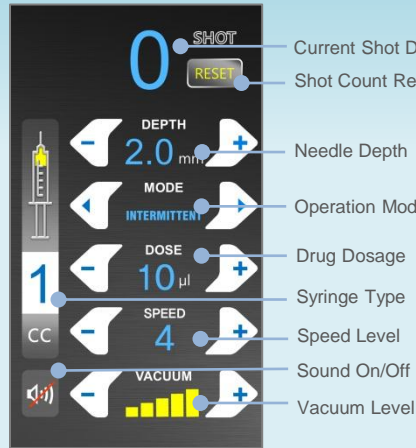

### Injector LCD

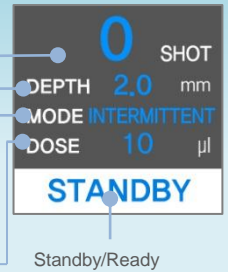

### Installation

#### 1. Turn on the power

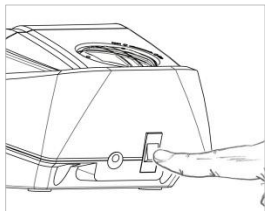

Turn on the power switch.

#### 2. Connecting multi-needle

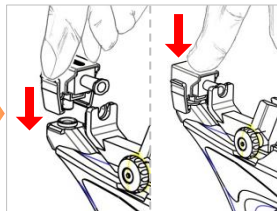

Match the multi-needle vacuum hall to the injector vacuum hall, and then press the upper part of the multi-needle until you hear a "click" sound.

#### 3. Remove safe tape

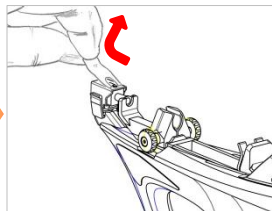

Remove the safe tape on the multi-needle.

#### 6. Fasten the syringe holder

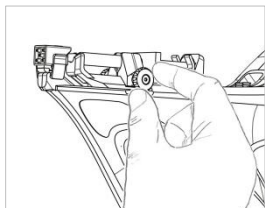

Fasten the syringe holder.

#### 5. Connecting syringe and multi-needle

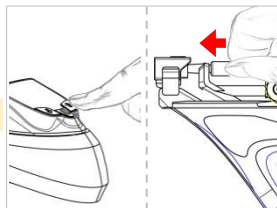

Connect the syringe to the multi-needle connect hall by pressing the forward button. After that push the syringe tightly by hand.

#### 4. Syringe Installation

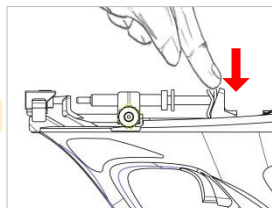

Put the syringe on the injector, then place the syringe piston correctly in the position holder.

### Preparation

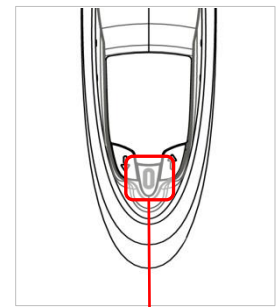

Standby/Ready Button

- Standby : Treatment standby mode
- Ready : Treatment ready mode



Move Back Button

- Move back the position holder.
- When pressed for more than two seconds, the position holder move back automatically, and press shortly once is to stop the motion.



Move Forward Button

- Move forward the position holder.

※ Press the injector trigger until removing the remaining air in the syringe before treatment.

# VITAL INJECTOR™ SYSTEM

## Quick Guideline

### Operation

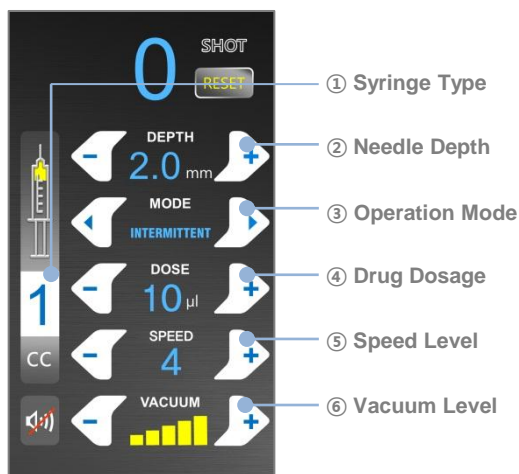

### ④ Drug Dosage

Set a target drug dosage of the treatment.

#### Intermittent Mode [Preset : 10 µl]

Type	Dose	Available Shot	Dose	Available Shot
1 cc Syringe	7 µl (1.4µl/psm)	143	13 µl (2.6µl/psm)	77
	8 µl (1.6µl/psm)	125	14 µl (2.8µl/psm)	72
	9 µl (1.8µl/psm)	111	15 µl (3.0µl/psm)	67
	<b>10 µl (2.0µl/psm)</b>	<b>100</b>	20 µl (4.0µl/psm)	50
	11 µl (2.2µl/psm)	90	25 µl (5.0µl/psm)	40
	12 µl (2.4µl/psm)	83	30 µl (6.0µl/psm)	33

Type	Dose
1 cc	1 cc/min, 2 cc/min, 3 cc/min
2 cc	1 cc/min, 3 cc/min, 5 cc/min
3 cc	
5 cc	

### ① Syringe Type [Preset : 1cc]

Select a correct syringe on the screen.

Syringe Type
1 cc, 2 cc, 3 cc, 5 cc

### ② Needle Depth [Preset : 2.0mm]

Set a target needle penetration depth.

Needle Depth Setting
Min. 0 mm ~ Max. 5.0 mm (Interval : 0.2mm)

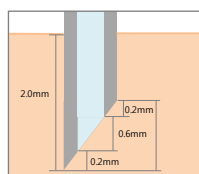

#### \* Needle bevel

Refer to the left figure

e.g.) [Set depth: 2.0mm]

→ [Target area: about 1.2 ~ 1.8mm]

### ⑤ Speed Level [Preset : 4 Level]

Depending on the drug viscosity, set the staying time of needles in the skin.



Low Viscosity [ Liquid type ]		High Viscosity [ Gel type : e.g. VITAL ]	
Dose	Speed	Dose	Speed
7~8 µl	1	-	1
9~10 µl	2	-	2
11~12 µl	3	7~8 µl	3
13~14 µl	4	9~10 µl	4
15 ~ µl	5	11~12 µl	5
15 ~ µl	6	13~14 µl	6

### ③ Operation Mode [Preset : Intermittent]

Select operation mode.

Operation Mode
<b>Intermittent:</b> When you pull the trigger once injected drugs.
<b>Continuous:</b> When you continue pulling the trigger, the drug is injected continuously.

### ⑥ Vacuum Level [Preset : 5 Level]

Set a target vacuum level.

